

## ENLARGED FLOOR PLAN

AVAILABLE 1,664 S.F. SPACE WITHIN AN  
EXISTING TWO-STORY OFFICE BUILDING

**PARCEL 28**  
**600 BALTIMORE DRIVE**  
**EAST MOUNTAIN**  
**CORPORATE CENTER**  
**WILKES-BARRE, PENNSYLVANIA**

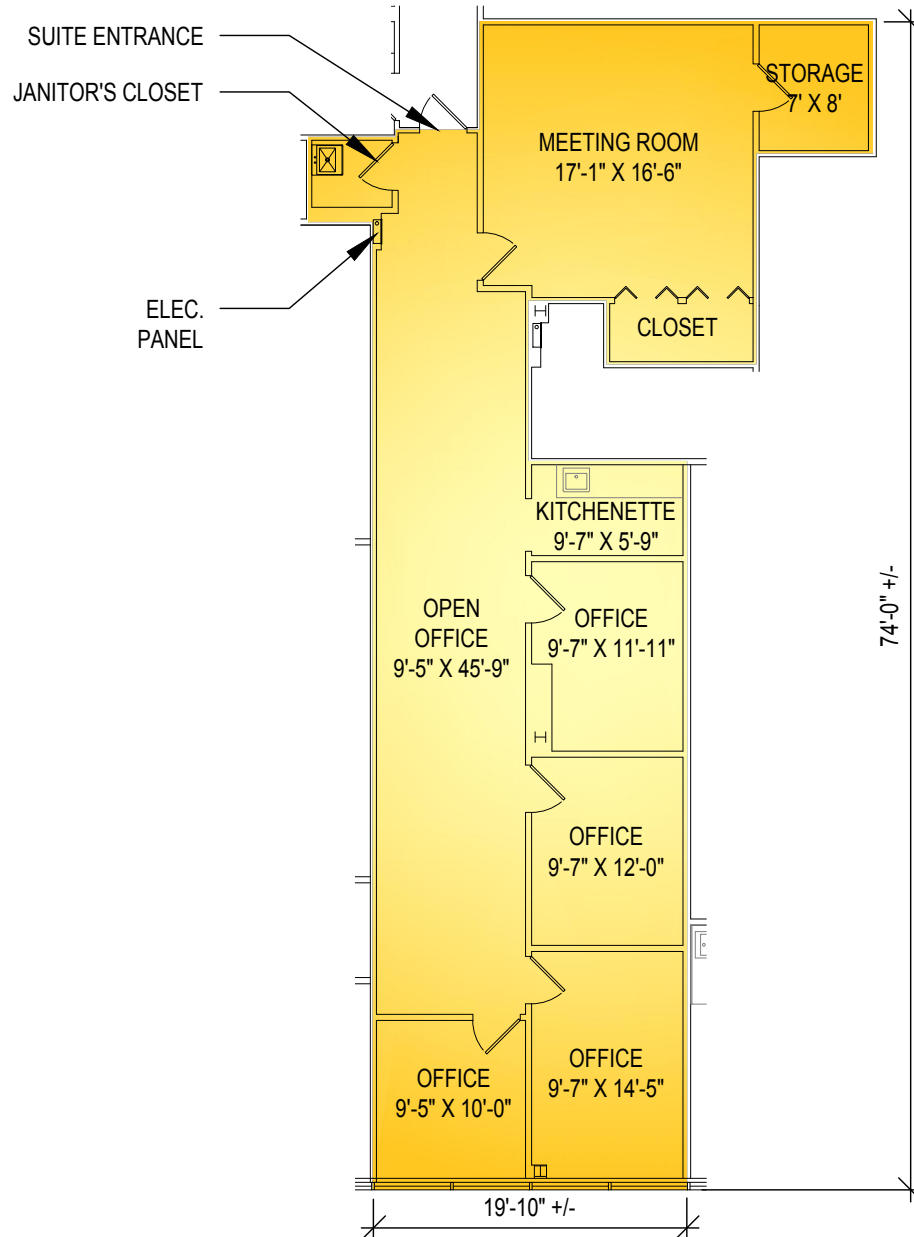

These plans have been prepared solely for  
marketing purposes for the exclusive use of  
-- Mericle Commercial Real Estate Services

F:\JOB\2071\IMDC\DWG-SPEC\IMKTG\IMKT- 600 BALTIMORE DR.-1664 SF SPACE 05192017.DWG CK

**570.823.1100**  
**mericle.com**



East Mountain Corporate Center  
100 Baltimore Drive  
Wilkes-Barre, PA 18702

*Developing Northeastern Pennsylvania's I-81 Corridor Since 1985*