

# EXISTING SITE PLAN

**AVAILABLE 172,012 S.F. SPACE  
WITHIN AN EXISTING 179,908 S.F. BUILDING**

**PENN BUSINESS CENTER  
350-390 N. PENNSYLVANIA AVE  
WILKES-BARRE, PA 18702**

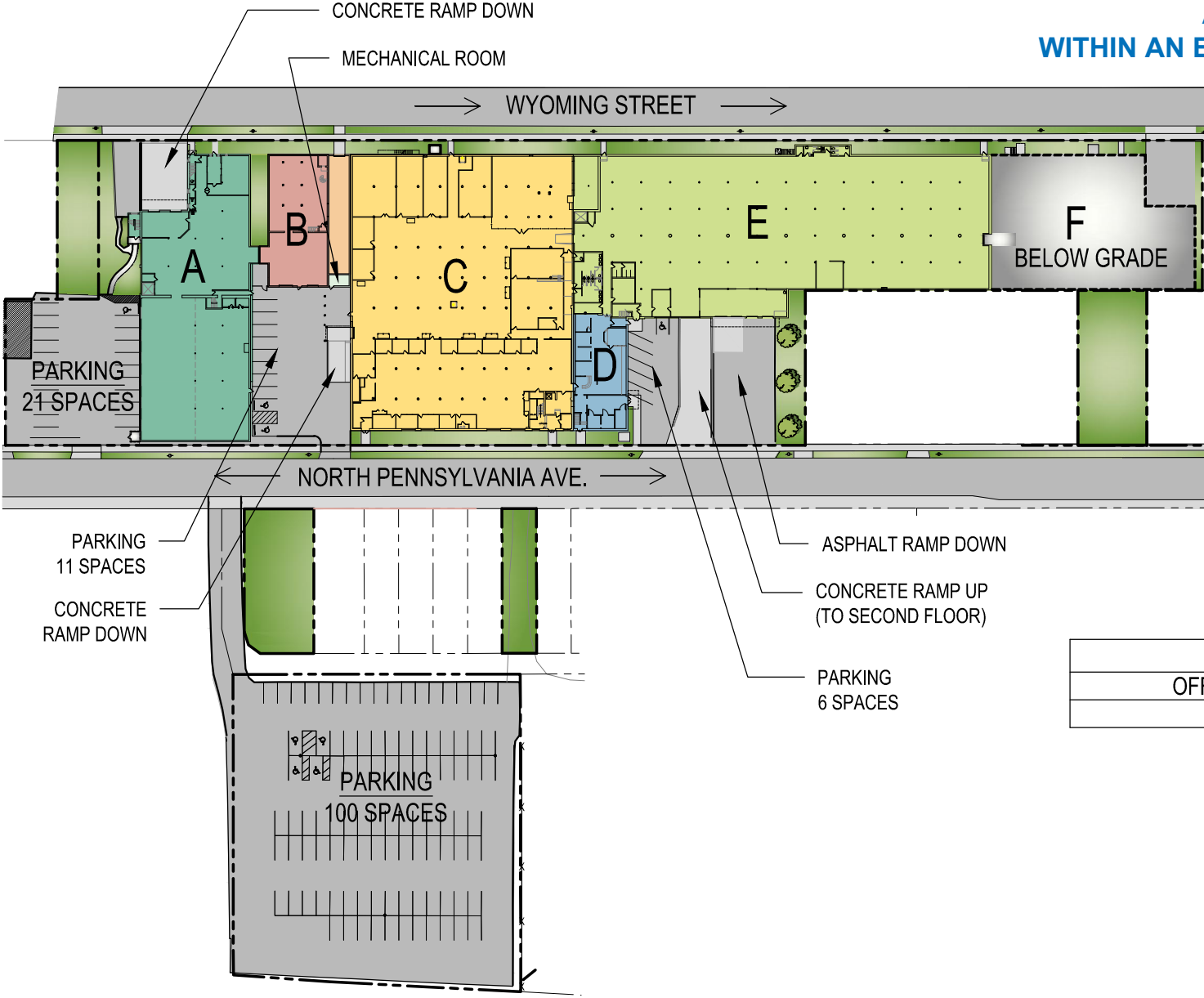

TOTAL AVAILABLE	172,012 S.F.
OFF-STREET PARKING	138
LOADING DOORS	14

These plans have been prepared solely for marketing purposes for the exclusive use of -- Mericle Commercial Real Estate Services

F:\JOB\2056\IMDC\DWG-SPEC\350 N. PENN-MARKETING-121113.DWG CK

**570.823.1100**  
mericle.com



East Mountain Corporate Center  
100 Baltimore Drive  
Wilkes-Barre, PA 18702

*Developing Northeastern Pennsylvania's I-81 Corridor Since 1985*